

LOTTO - 5 -
RILIEVO DEGLI IMMOBILI SITI IN MESAGNE (BR), ALLA VIA AGRIGENTO, 60, PIANO TERRA E INTERRATO, CENSITI AL N.C.E.U. DEL COMUNE DI MESAGNE AL FOGLIO 54, PARTICELLA 2147 SUB 5 E 49.

PIANTA PIANO TERRA

Scala 1:100

hu: 2,73 ml.

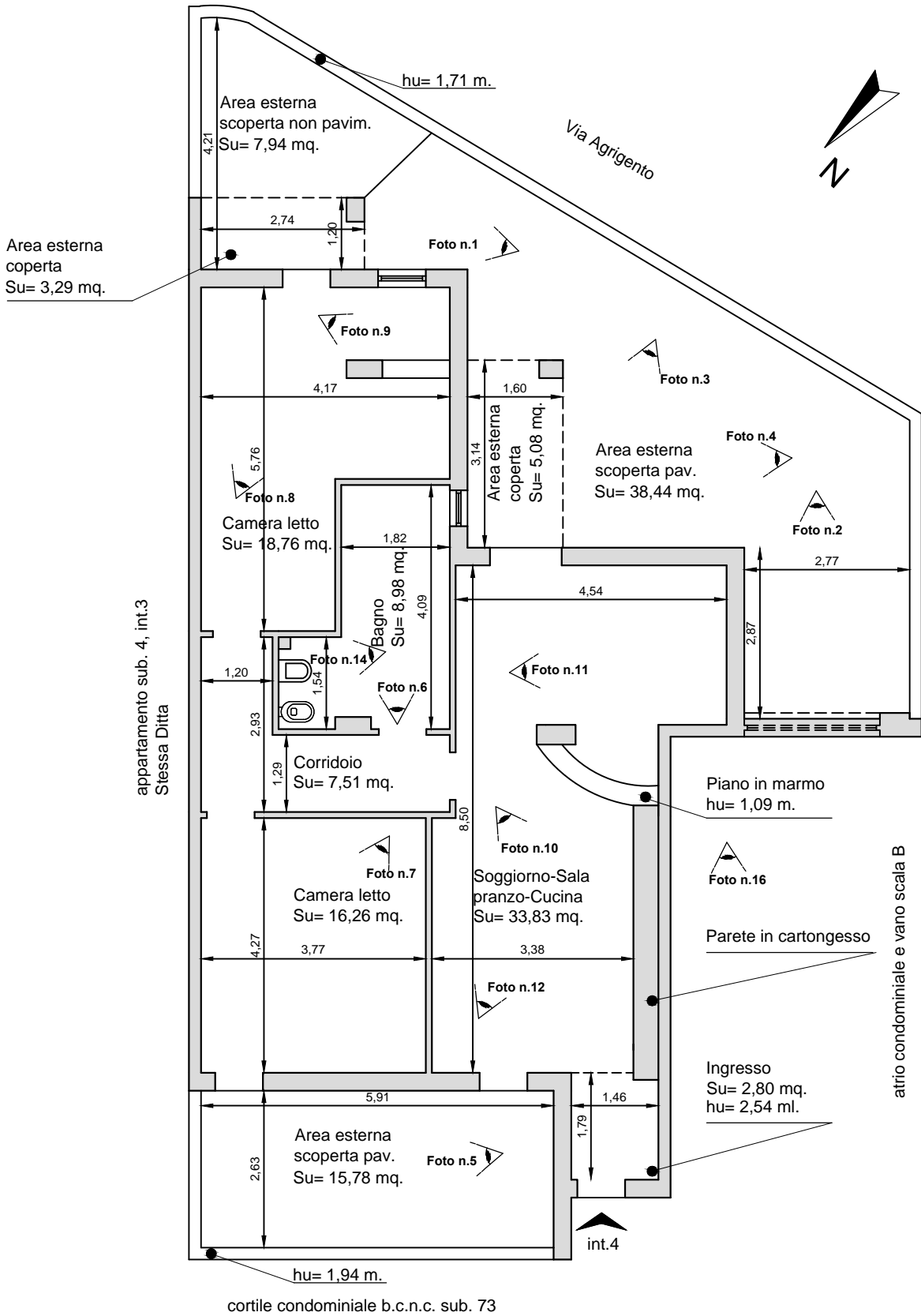

PIANTA PIANO INTERRATO

Scala 1:100

hu: 2,60 ml.

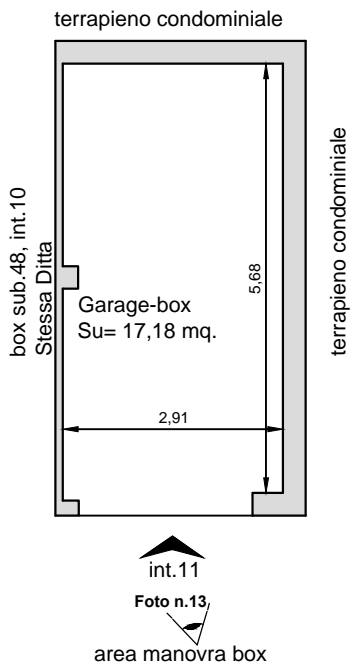

Il C.T.U.
(Ing. Giuseppe BARBARITO)